

t240CK

2.4m C-band and Ku-band
Marine Satellite TV Antenna System



Remote management solution

The t240CK can be accessed, monitored and controlled from any location in the world by accessing the ACU's built-in web based Monitoring and Control software. Additionally, routine maintenance activities can be automated. These functions include firmware upgrades, tracking parameters, logging performance data, and system diagnosis.

Simultaneous C and Ku-band TV reception

The t240CK is designed to receive both C- and Ku-band satellite signal simultaneously. With multiple RF outputs from the below deck multi-switch, both C and Ku-band receivers can be connected, simplifying installation and providing seamless operation.

Dedicated management ethernet port

The ACU of the t240CK Provides a convenient Management Ethernet Port on the front panel. The Management Port supports DHCP network connection by default allowing quick network access without additional PC IP configuration.

Easy installation, setup and operation

With the t240CK, installation and setup are easier than ever. Once a satellite's signal peak position is acquired during the first-time setup, the antenna system will re-adjust all the parameters (bow adjust, home sensor offset, azimuth and elevation position) automatically even after it reboots to save a tremendous amount of time and effort for the operators.

Hands-free WorldView™ LNB

The t240CK incorporates Intellian's patent pending worldview LNB which receives multi-band and multi-polarization satellite TV services around the globe. This eliminates the need to climb into the radome to change the LNB each time when travelling to a different satellite TV service region.

Gyro-free satellite search capability

Intellian's new generation Gyro-free satellite search function enables the t240CK to acquire and track the satellite without requiring a separate input from the ship's gyrocompass.

t240CK 2.4m C-band and Ku-band Marine Satellite Antenna System

Technical Specifications

Physical	
Radome Height	410cm / 161.4"
Radome Diameter	330cm / 130"
Reflector Diameter	240cm / 94"
Weight	630kg / 1,389lbs (Excl. A/C)
Environmental	
Operating Temp. Range	-25°C to +55°C / -13°F to +131°F
Storage Temp. Range	-40°C to +80°C / -40°F to +176°F
Water Ingress	IPX6
Approvals	CE / FCC
Warranty	3 year parts and 2 year labor
Performance	
Platform	3-axis : Azimuth, Elevation, Cross-level
Reception Frequency	C-band: 3.4~4.2GHz Ku-band: 10.7~12.75GHz
Polarization	C-band: Linear Ku-band: Linear & Circular (Auto Switchable)
Minimum EIRP	C-band: 31dBW Ku-band: 35dBW
Feed Assembly	Dual C-band / Quad Ku-band Linear, 2 C-band + 2 Ku-band or Quad Ku-band simultaneously
Skew Control	Automatic Skew-angle Control
Azimuth Range	Unlimited
Elevation Range	-15° to +120°
Ship's motion	Roll ±25°, Pitch ±15°, Yaw ±15°
Turning Rate	Up to 12°/sec and 5° /sec ²
RF Output	Quad Output
Antenna Control Unit	
Dimensions (WxDxH)	43.1cm x 38.1cm x 4.4cm / 17"x15"x 1.7"
Weight	3.5kg / 7.7lbs
Display	2 Line 40 Character Graphic VFD Module
PC Interface	RS232C (57600bps, 8, N, 1) / USB
Gyrocompass Interface	NMEA 2000 / 0183
Remote Access	TCP / IP / Wi-Fi
Power Requirement	100~240V AC, 50~60Hz
Power Consumption	Typ. 50W, Max 100W

System Diagram

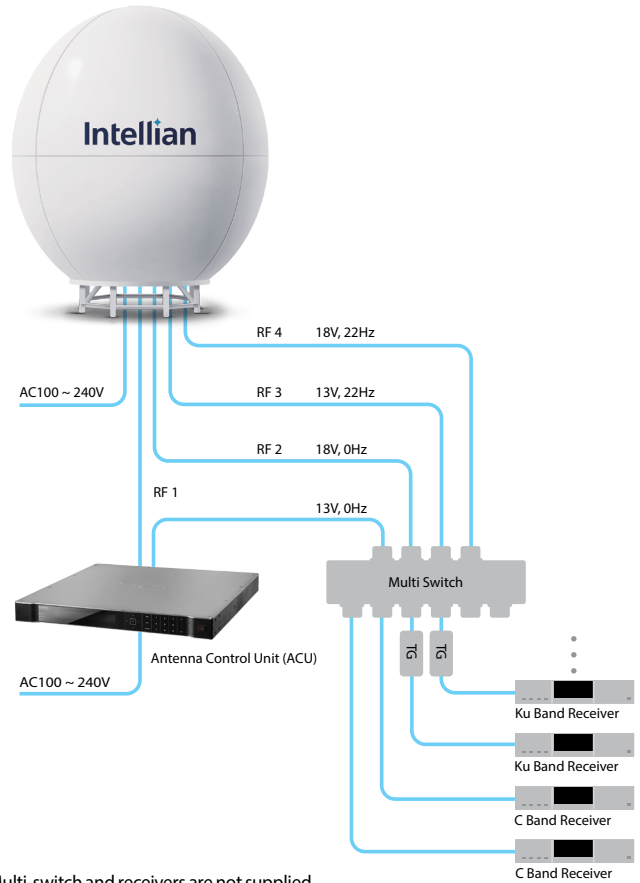

System Dimension

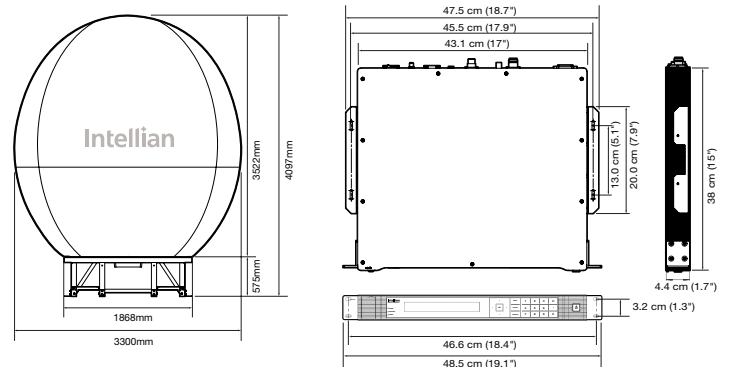

Global HQ
Innovation Center
 Intellian Technologies, Inc.
 T +82 31 379 1000
 F +82 31 377 6185

APAC
Seoul
 Intellian Technologies, Inc.
 T +82 2 511 2244
 F +82 2 511 2235

Americas
Irvine
 Intellian Technologies USA, Inc.
 T +1 949 727 4498
 F +1 949 271 4183
 Toll Free +1 888-201-9223

EMEA
Rotterdam
 Intellian B.V.
 T +31 1 0820 8655
 F +31 1 0820 8656