



## EM-TRAK – COMMITTED TO VESSEL SAFETY & SECURITY

With over twenty five years of product design and engineering heritage our products offer the very best in quality engineering, reliability, usability and operational performance. To achieve this unique mixture of quality and performance we develop and deploy the most advanced core technologies coupled with proven professional standard product design.

## EM-TRAK WARRANTY & SUPPORT

Em-trak is committed to providing the highest level of customer service. Our comprehensive global warranty ensures that in the unlikely event of a problem it will be resolved to your full satisfaction in the shortest possible time.

Further information about our warranty programme and instant advice and support for all our products can be obtained from our web site [www.em-trak.com](http://www.em-trak.com) or your local authorised em-trak dealer.

The em-trak B400 is an aid to navigation and must not be relied upon to provide accurate navigation information. AIS is not a replacement for vigilant human lookouts and other navigation aids such as Radar. The performance of the B400 may be seriously impaired if not installed as instructed in the user manual, or due to other factors such as weather and or nearby transmitting devices. Compatibility with other systems may vary and is reliant on the third party systems recognising the standard outputs from the B400. em-trak reserves the right to update and change these specifications at any time and without notice.

### Head Office:

em-trak Marine Electronics Ltd  
Wireless House  
Westfield Industrial Estate  
Midsomer Norton  
Bath BA3 4BS  
United Kingdom

T +44 (0)1761 409 559  
F +44 (0)1761 410 093  
E [enquiries@em-trak.com](mailto:enquiries@em-trak.com)  
W [www.em-trak.com](http://www.em-trak.com)

### USA Office:

em-trak Marine Electronics Ltd  
470 Atlantic Avenue  
4th floor  
Boston  
02210  
USA

T +1 617 273 8395  
F +1 617 273 8001  
E [enquiries@em-trak.com](mailto:enquiries@em-trak.com)  
W [www.em-trak.com](http://www.em-trak.com)

## EM-TRAK B400 FEATURES & SPECIFICATION

### DIMENSIONS & WEIGHT

- > 152mm x 165mm x 79mm (W x H x D)
- > 2 kg

### DATA INTERFACES

- > NMEA0183 (IEC61162-1/2) bi-directional ports x3
- > NMEA0183 (IEC61162-1/2) sensor inputs x3
- > NMEA2000
- > WiFi

### POWER

- > 12 to 24V DC
- > Power consumption < 12W

### CERTIFICATION

- > CE marking under RED for Europe
- > FCC
- > USCG
- > ISSED (Industry Canada)

## WHAT'S IN THE BOX

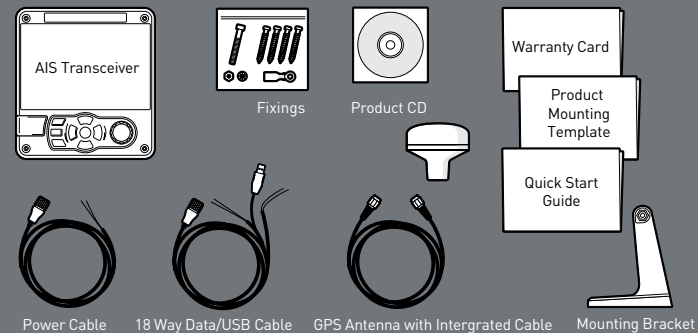



PROFESSIONAL STANDARD RELIABILITY

Product Code: 427-0003

# B400

AIS CLASS B (5W - SOTDMA)





**THE B400 IS A FULLY CERTIFIED SOTDMA TRANSCIVER WITH 2.5 TIMES THE TRANSMIT POWER OF STANDARD CLASS B.**

#### PRODUCT HIGHLIGHTS

- > Certified 5W SOTDMA Class B
- > Water and weather proof IP66 and IP67
- > Integrated WiFi
- > High resolution colour display
- > Integrated charting (CMAP) with target overlay
- > Multiple target management functionality
- > NMEA0183 & 2000



#### > WEATHER PROOF

Completely water & weather proof (IP66 & IP67) with anti-shock & vibration.



#### > HD COLOUR DISPLAY

Full charting, dual text & graphic interface, and day and night display modes.



#### > ERGONOMIC INTERFACE

Robust buttons and rotary knobs ensure easy and reliable operation in all conditions.



#### > CONNECTIVITY INTELLIGENCE

NMEA0183, 2000 and WiFi make connectivity with other bridge systems quick and easy.



## > KEY FEATURES

The B400 is a powerful and tough AIS Class B ideally suited for offshore and professional mariners.

As an SOTDMA type Class B, the B400 enjoys transmit power of 5W instead of the standard 2W as well as transmit priority in busy areas. This translates into enhanced operational performance.

The B400 is a robust, weatherproof, fully integrated unit incorporating a high resolution full colour display, CMAP charting and a broad range of functionality. Its flexible connectivity options that include WiFi, NMEA0183 & 2000 make installation and interoperability with your other systems quick and easy.

A wide range of functionality including MOB & SAR alert tracking, alert tracking, real time AIS AtoN sensor information display, filters, alerts and much more make this an essential device for any serious mariner.

- > Internationally certified AIS Class B (5W-SOTDMA)
- > Single fully integrated transceiver
- > Water and weatherproof - IP66 & IP67 certified
- > Integrated HD colour display
- > Full electronic chart operation
- > Multi-lingual menu options
- > Day and night display modes
- > Integrated long range WiFi
- > Dual NMEA0183 and NMEA2000
- > Ruggedized - protection from shock and vibration
- > MOB & SAR alert and tracking system
- > Continuous internal fault check and diagnosis system
- > Intelligent connectivity for all bridge systems: Gyro, ECDIS, VHF DSC etc
- > Receives and decodes all AIS message types
- > Ultra power efficient
- > Temperature and shock protection system

## > B400-BLACK FOR NAVY & COAST GUARDS

The B400-BLACK provides additional custom functionality such as sophisticated encryption, enhanced satellite detection and other features for Navies and Coast Guards. Contact us with your precise requirements.



**Mackay Marine**  
+1 281 479 1515 [marinesales@mackaymarine.com](mailto:marinesales@mackaymarine.com)  
**Mackay Communications, Satellite Solutions**  
+1 919 850 3100 [satserv@mackaycomm.com](mailto:satserv@mackaycomm.com)  
**Mackay Marine Canada**  
+1 902 469 8480 [sales.canada@mackaymarine.com](mailto:sales.canada@mackaymarine.com)  
**Mackay Govt. Group**  
+1 904 880 4633 [government@mackaycomm.com](mailto:government@mackaycomm.com)

## > FEATURE HIGHLIGHTS

### MAN OVER BOARD TRACKER



Upon receipt of a MOB / SART alert, the B400 allows you to easily locate and track the signal, providing continuous clear bearing and distance information in real time.

### 5W TRANSMIT POWER



The B400 is a certified SOTDMA Class B transceiver with a powerful 5W transmitter for enhanced range. Ideal for commercial and offshore sailors.

### THE EM-TRAK RANGE

